

THE

Pedestal



2017 Fall Tour (Two Days)

Indiana Association of Professional Soil Classifiers (IAPSC)

Indiana Association of Professional Soil Classifiers

Fall Tour

Day One Thursday September 14th
Location: Clermont County, Ohio Fair Grounds, Municipal Building,
1000 Locust St, Owensville,
Ohio 45160 (\$55.00)

(See attached Ohio newsletter for details)

Day Two Friday September 15th
Location: SOUTHEAST PURDUE
AGRICULTURAL CENTER
4425 East 350 North
Butler, Indiana 47223 (\$25.00)

When: September 15, 2017

Agenda (Eastern Daylight Savings Time)

- 9:00 - 9:30 **Registration:** Dena Anderson
IAPSC Secretary/Treasurer
(Donuts and coffee will be served)
- 9:30 - 9:45 **Welcome and Introductions:**
Lambda Mort, IAPSC President
- 9:45 - 10:00 **Dena Anderson:** Overview and
History of Field Sites
- 10:00 - 10:30 **Dr. Don Franzmeier** – Fragipan
Formation.
- 10:30 - 12:00 **Travel to and review sites/pits in ag
land vs. forest land Cobbfork and
Avenburg soils.**

12:00 - 1:00 **Lunch and Door Prizes**

1:00 – 1:30 **IAPSC Business Meeting**

1:30 – 2:00 **Byron Jenkinson** - Muscatatuck
Research and Iris Tubes

2:00 – 3:00 **Field sites in Cincinnati and Blocher
soil pits – Septic Interpretations**

3:00 **Adjourn** – Safe Travels

**The Indiana Association of Professional Soil
Classifiers (IAPSC)** is a not-for-profit organization of
soil scientists who are interested in the field study and
evaluation of soils.

Lambda Mort, President
Dave Ortel, Past President
Randy Staley, President Elect
Dave Ralston, Vice President
Dena Anderson, Secretary-Treasurer
Norm Stephens, Pedestal Editor

<http://www.isco.purdue.edu/irss/iapsc.html>

**This year's Fall Tour is two days. You may
attend either day, or both days. Choose the best
option to fit your schedule. This is a chance to
earn additional CEUs for those who need them.**

[For anyone camping: Scot Haley has site 23 at the
Muscatatuck Park in Jennings County, Indiana. He will be
camping September 13, 14, and 15th. Feel free to reserve a
space as close ... or as far away as possible from Scot at:](#)

<http://www.muscatatuckpark.com/campground.php>

[Indiana Campers going to Ohio Thursday morning are
planning to carpool.](#)

[See attached Ohio Newsletter for Ohio Camping information.](#)

New!

This is the link to various items for the joint meeting between Indiana and Ohio on September 14-15th. It is a work in progress at the moment as some tweaks are done to the agenda/formatting, additional documents, etc. This is something we thought people could pull up on their smartphones. Included are several links to AOP, IAPSC, map of the tour sites, lodging, etc. Let us know of anything that needs to be added and any suggestions you have.

<http://arcg.is/1H8XSz>

Indiana Registry of Soil Scientists

(As written on the IRSS web site.)

The Indiana Registry of Soil Scientists is a program that establishes ethical standards and education, examination, and work experience criteria for Indiana Registered Soil Scientists.

<http://www.oisc.purdue.edu/irss/>

Pedestal

We need your stories and photographs for the Pedestal. Please email them to:

norm.stephens@in.usda.gov

Or mail them to:
Norm Stephens
NRCS-USDA
6013 Lakeside Blvd.
Indianapolis, Indiana, 46278

See the Pedestal in color:

Electronic copies of Pedestal will eventually be found at:

<http://www.iapsc-in.com/#!documents/c1po4>

Membership Email Addresses

If you did not get an email notification of the electronic Pedestal it means we no longer have a valid email address for you. Please submit your current email address to Norm Stephens:

norm.stephens@in.usda.gov

Email is the most cost effective way the IAPSC can keep you informed of any last minute changes in meeting plans, or time sensitive notifications of importance to the group.

Soil Classifiers:

Periodically (once every couple of weeks) I send, via email, notices on happenings within the National Cooperative Soil Survey. The subjects vary, but include job vacancies, workshops, soils videos, NCSS Newsletters, Soil Taxonomy updates, updates on Web Soil Survey, etc. If you are not currently on my email list (which is currently at about 120 folks) and would like to be added please send your current email to me at gary.struben@in.usda.gov Feel free to share this with others if you know of folks you think might be interested, but may not be IAPSC members. Maybe we can recruit some new members!

Of course, if you want to be taken off the list, just email me that too! (Except for the NRCS staff who will get them whether they want them or not!)

Gary R. Struben
Indiana State Soil Scientist
USDA Natural Resources Conservation Service
6013 Lakeside Blvd.
Indianapolis, IN 46278
317-295-5885 (Office)
317-354-5235 (Cell)
gary.struben@in.usda.gov

Meeting Location



Camping Location



Soil ... A Colt's Cheerleader ... and Murder

By Norm Stephens

Soil Survey activities involve a lot of the same thing on a different day, but occasionally you run across something unusual in the files as you are researching data map units and this event dates back to a letter written to State Soil Scientist Ray Sinclair in February of 1987. Tim Murphy a Criminalistics Specialist for Marion County, Indiana requested assistance in identifying and comparing soil samples in a murder investigation.

Myron Keeney a local developer had been reported missing by his daughter. During the first few weeks of the police search for Myron Keeney there were two extortion calls made. One call was to the Keeney household demanding a \$100,000 for his release and another call to a restaurant where his daughter Amanda worked demanding Ty and Amanda get back together. Amanda Keeney was a former Colt's Cheerleader who worked at a local restaurant as a hostess and Ty Thixton worked there as a busboy. Amanda dated Ty from July to October of 1986 and from all accounts it was a stormy relationship and a relationship that Myron Keeney strongly disapproved of. Shortly after Myron Keeney disappeared ... his credit cards were used during a lavish spending spree by someone signing the receipts as Matt Keeney. One of the items purchased was an expensive black dress ... which Ty Thixton gave to Amanda Keeney. Police stopped Thixton for driving with an expired license and noticed a strong order of decomposition coming from the trunk of his car. The car was towed in and searched. Some blood was found in the trunk of the car. Thixton denied having any knowledge of the disappearance of Myron

Keeney. Police tracked down a close friend of Thixton who was now in the Navy and being trained at the Great Lakes Naval Station. Eric Owen admitted to being with Ty Thixton the night Myron Keeney was murdered and that he helped clean up the scene and bury the body. Police later proved that Eric Owen was the one who signed the credit card receipts as Matt Keeney. Police went to the site where Owens told them Keeney was buried, but all they found was an empty hole and a couple of shoes nearby ... and one shoe with blood in it.



Police detectives returned to the Great Lakes Naval Station to interview Eric Owens again and ask him if there were any other locations where Thixton might have buried Keeney. Owens told them Thixton had also mentioned a possible site being in the ravine behind his house. Police found the second burial site within sight of Thixton's bedroom window.



A police search of the Thixton household found shovels with soil on them.



I'd think soil on a shovel would be a normal find and the police were wanting our help in figuring out if the soil on the shovels were related to either of the two burial sites. Aerial photographs of the burial sites looked like your typical glacial landscape on the till plain. Unfortunately, I did not find a copy of what our answer to this request was, but if it were today ... I can't imagine there would be much we could do with the small amount of soil found on a shovel. Still ... I wondered what might be different in the two burial sites and I thought I would locate where they were found.



Myron Keeney's home and burial site one.



Ty Thixton's home and burial site two.

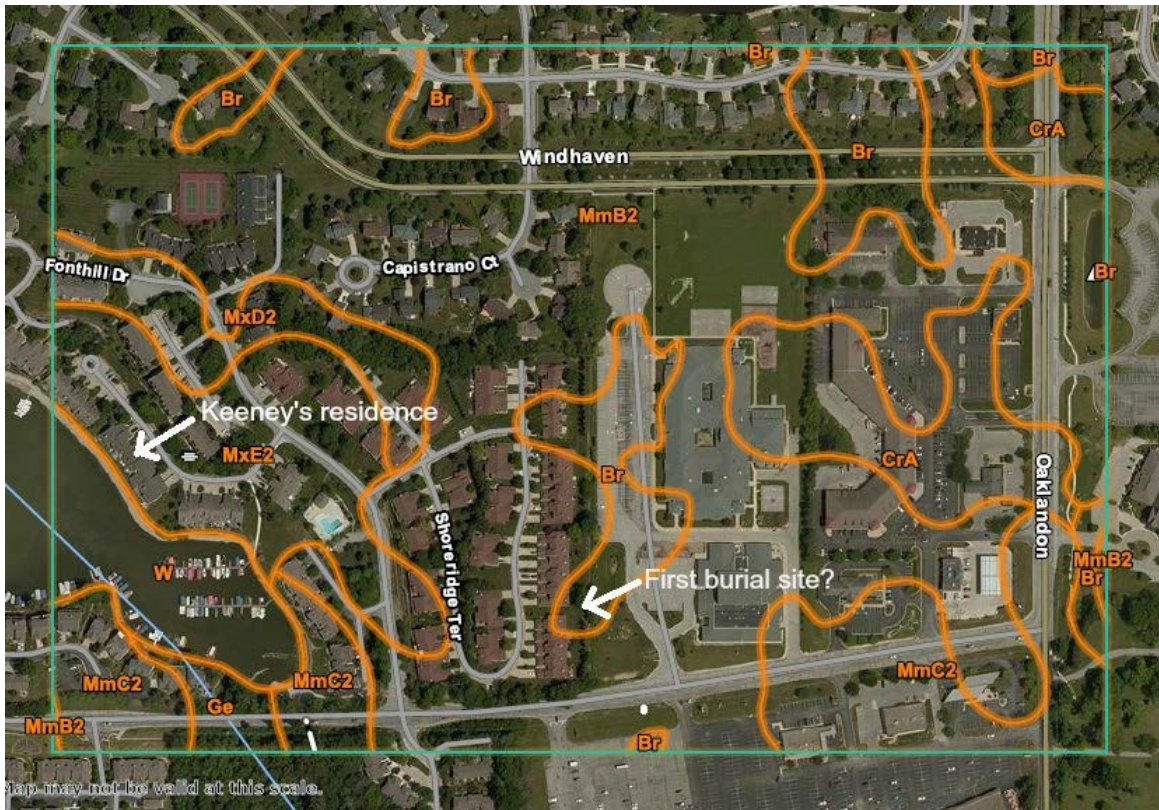

The first burial site was very difficult to locate due to the oblique nature of the aerial photograph, but the grave photo suggests possibly an aquoll soil which should put it in the map unit mapped Brookston. Pretty much your typical glacial landscape. A lot of urban development has taken place since the 1986 crime photos were taken and the color in the photos has degraded a bit, but I'm pretty sure the first burial site was in this area. I have been by this location many times in the past and the mapping appears to be pretty representative of what I've seen there. I'm guessing Thixton feared development would uncover the body and by moving it to a location he could watch closely ... it would be easier to protect. Both sites were shallow burials.

The second burial site was easier to locate and is found in your Ockley-Sleeth-Westland association along the White River drainage. Still ... Owens described the site as being in a ravine behind Thixton's house ... and being that I haven't run across a lot of Sleeth ravines ... I would be interested in seeing the site and seeing if it was possibly mislabeled. I also find it unusual with the heavy development around it to still be undeveloped. It could also just be a difference in what I consider a ravine and what Owens considers a ravine. Till soils are found nearby which is pretty standard on the till plain. The glacial White River had much larger flows during the ice melt off than what we experience today. The glacial White River overflowed its valley banks and dispersed water across the till plain. Stratified outwash sediments can be found in many places on the till plain and till remnants found within outwash terraces and flood plains.

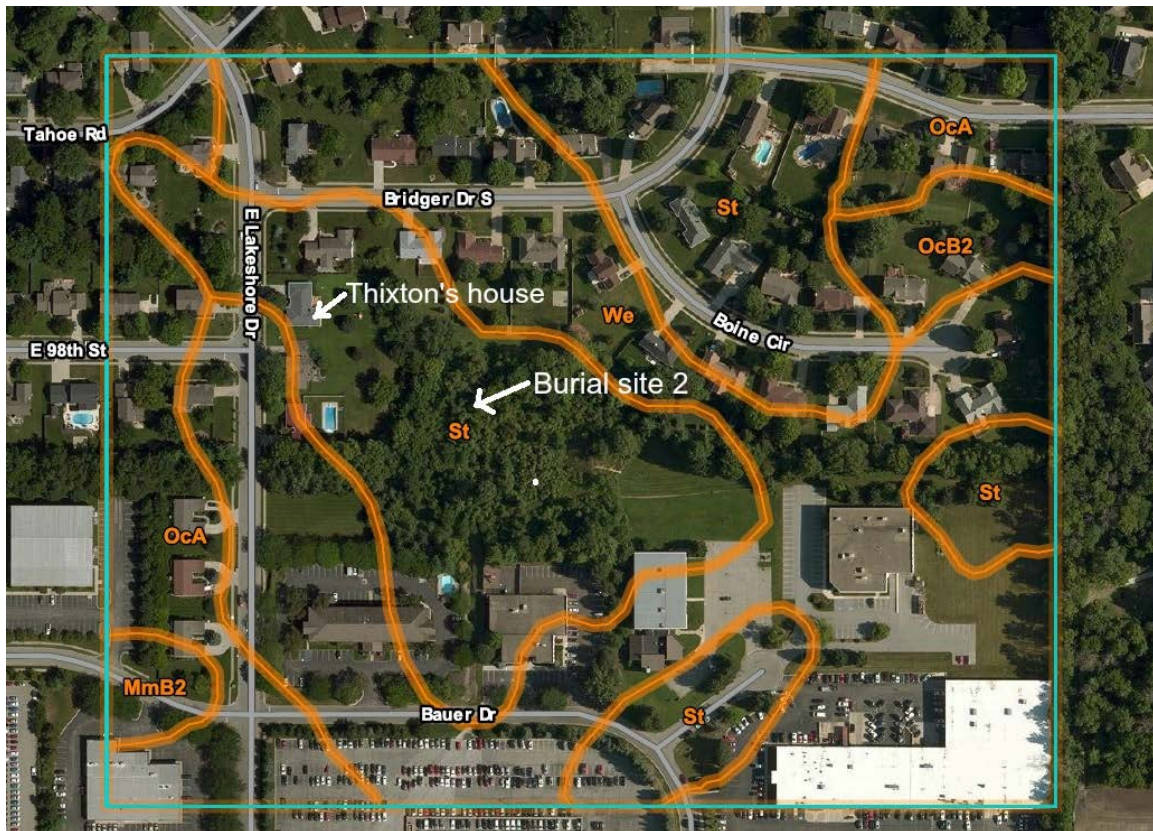

Soil samples were sent off to the FBI lab and I do not know outcome of those samples, but guessing from the outcome of the trial ... the results were not substantial in the case. Ty Thixton was found not guilty of the murder of Myron Keeney. Interviews with jurors after the trial found they did not believe he was innocent, but that they did not feel the prosecution proved him guilty by the legal definition of “beyond reasonable doubt”. The police early on in the investigation tried to link Thixton to the murder of another man who was also beaten with a blunt object and strangled with a cord in the same fashion as Myron Keeney was. Both homes were burglarized in those cases. Property belonging to Myron Keeney was also found in the possession of two of Thixton’s friends, but not in the possession of Thixton. I think this was the reasonable doubt the defense used to get Thixton off of the murder charge. It is clear from the news articles that Owens and Thixton were both involved in home burglaries in the past and probably worked together on them. The defense also discredited the testimony of Owens when they got him to admit he was also in the house at the time of Keeney’s death which was contrary to his original story told to the police of being asleep outside in the car while Thixton was in the house talking to Keeney about dating his daughter. Owens was charged with forgery, but nothing in connection with the murder as a part of his deal with police to testify. Thixton ended up with a \$10,000 fine related to the forgery charges and would have been released with time served, but the burglary violated his earlier parole release and was being held for a ruling on that. I did not find an article on that ruling, but I’m guessing he had to serve out the remainder of the earlier six year sentence.



2017 FALL TOUR REGISTRATION FORM

For Friday September – 15th

Registration fee includes **hot lunch.**
Help us keep costs low by registering early.

Send in your check today!

Registration Fee \$25.00 before August 25th.

LATE FEE after - \$30.00

If at all possible register before August 25th

Make checks to I.A.P.S.C. Inc.

Clip and mail to Dena Anderson IAPSC Sec./Treas at:

6939 S. Majors Rd

Hanover, IN 47243

Questions, Call Dena at 812-525-6433, or 812-591-3770

Name(s): _____

Members please update the following, if needed:

Name: _____

Address: _____

Phone No: _____

E-mail address: _____

2017 FALL TOUR REGISTRATION FORM

For Thursday September – 14th

Registration fee includes **catered lunch**.
Help us keep costs low by registering early.

Send in your check today!

Registration Fee \$55.00 before August 25th.

Registration closes on August 25th

A registration fee of \$55 for Day One includes the technical program, a catered lunch, and bus transportation between study sites. Lodging/camping is on-your-own. *Note: Students actively enrolled in a university program receive free registration from the Association of Ohio Pedologists for Day One but must register in advance.*

Make checks to Association of Ohio Pedologists

Clip and mail to:

Jon Gerken

5890 Rauch Rd

Carroll, Ohio, 43112

Name(s): _____

Students:

Send the following information by September 1 to Mr. Jon Gerken at the above address:

Name: _____

University: _____

Program or Major: _____

Faculty Advisor: _____

ASSOCIATION OF OHIO PEDOLOGISTS

OHIO SOIL PROFESSIONALS

www.ohiopedologist.org

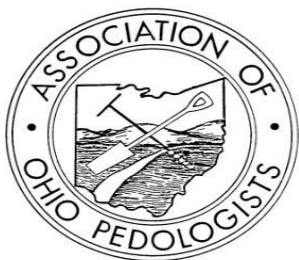

PRESIDENT 'S FALL MESSAGE

From Larry Tornes



I would like to take this opportunity to thank the AOP Summer//Fall Workshop Committee that have worked so hard with the Executive Council in organizing an outstanding soils training workshop with the Indiana Association of Professional Soil Classifiers. See the draft agenda for this September 14 and 15 workshop in this newsletter.

Under Frank Gibbs leadership in the Ohio portion of the workshop, this group has developed a program with field stops that gives the membership and others from ODNR, NRCS, students, Health Departments, etc. the opportunity to study soils and geology in the Illinoian glaciated portion of Ohio and Indiana.

Many special field and laboratory studies have been conducted to determine whether the soils have fragipans. This is an issue soil consultants face daily when completing soil site evaluations in soil associations where fragipans are common. You can easily determine whether most soils have fragipans in backhoe pits; however, it is more of a challenge where this determination must be made with a bucket auger. Hope you can join us for this workshop.

**The Association of Ohio Pedologists and Indiana Soil Classifiers
Combined Workshops**

September 14-15, 2017 (Thursday-Friday)

"Soils of The Illinoian Till Plain ~ Clermont/Cobbsfork and Associated Soils"

Register for one day or register for two and double your fun!

Sept 14: Clermont County, Ohio Fair Grounds, Municipal Building, 1000 Locust St, Owensville, OH, 45160

Sept 15: SouthEast Purdue Ag Center, 4425 East 350 North, Butlerville, IN, 47223

10.75 CEUS available for \$80 dollars and two days.

The AOP continually strives to offer training sessions that expand our members hands on experiences as well as earn CEUs. This year's training with our colleagues from Indiana will provide experience, CEUs and low cost. **Please note the registration deadline fo Day 1 is Aug. 25** . We will be using busses on Day One and we need to commit on the number. The deadline on day 2 is Sept. 1. To receive the block rates at the hotels also requires early reservations with the hotels.

AOP and the ISCC do have separate registrations to keep costs and fees straight, you will need to send a separate registration to Indiana for Day 2. The total cost for the 2 days is \$80, \$55 for Day 1 and \$25 for Day 2. Please read carefully!

Come and study these high silt soils both states. They are hard to manage, poorly drained and low in organic matter in terms of Soil Health Practices, Drainage, Septic Applications and Hydric Soil Indicators.

Listen to geologists explain the formation of the Illinoian Till and associated Paleosols. Examine a Deep Core Sample and Stream Cut into the Tills.

Examine Soil Pits and Discuss Lab Data at Instrumented Sites under different Management Practices. Discuss the Differences of these Soils and their Challenges with Soil Scientists across the State Line.

Registration: \$55 for Day One in Ohio (7.25 SSSA CEUS) and/or \$25 for Day Two in Indiana (3.5 CEUS)

We are inviting students from OSU and Wilmington College for Day 1. This will be an opportunity to get to know them on the busses and in the field. Our replacements are extremely important to AOP.

Lodging & Social Arrangements (On Your Own)

Sept 14th at 7:00pm - Optional Meal Social at Pappadeaux 11975 Northwest Blvd., Springdale, OH 45246

<https://pappadeaux.com/location/42> (North side of I-275 just off of SR 4)

Email your Reservation by Aug. 31 to Frank Gibbs at

fegibbs21@gmail.com

Sept 14th Evening: Winton Woods Camp Ground 10245 Winton Road, Cincinnati, OH, 45231 Experience The Indiana Classifiers Annual Camp Out: Wild Tales and Wild Turkey around the Camp Fire. Camp out or just come to visit a while (carpooling highly recommended). Reservations at: <http://www.greatparks.org/parks/winton-woods/winton-woods-campground> (Book Soon...!!!).

Nearby Hotel Blocks Reserved at Special Rate on the I-275 Outer belt in Northern Cincinnati:

Spring Hill Suites, 12001 Chase Plaza Drive, Cincinnati, Ohio 45240: 25 rooms until August 13th at the rate of \$98.00 per night plus tax (\$114). These rooms have a king bed with pull-out or two double beds with a pull-out.

Quality Inn & Suites, 2463 East Sharon Road, Cincinnati, Ohio 45241: 25 rooms until August 22 \$81/night plus tax. These rooms have a king bed or two queen beds.

La Quinta Inn, 12150 Springfield Pike, Cincinnati, Ohio 45246: 25 rooms until August 23 \$62/night plus tax; these rooms also have a king bed or two full beds.

Book Soon to Receive the Discounted Rate!!!

THE TENTATIVE AGENDAS FOR DAYS ONE AND TWO ARE BELOW. We use the word tentative since the weather can always interfere and sometime adjustments are made on the fly. These areas are mainly wet normally. But we hope and plan for the best experience.

Tentative Agenda and Registration (Day 1 in Ohio)

Agenda Sept 14th-Day One (Thursday)

Clermont County, Ohio, Fair Grounds: Municipal Building, 1000 Locust St, Owensville, Ohio, 45160

8:00 – 9:00 – Registration, Donuts and Coffee (Clermont and Cobbsfork Cores Displayed to Examine)

9:00 – 9:15 – F Gibbs and D Anderson - Discussion of Field Trips Activities and Joint Workshop Objectives

9:15 – 9:30 – Mike Angle (Geologist) Power Point Discussion of Illinoian Till Formation/Distribution in Ohio and Indiana

9:30 – 11:40 – Group Splits, Group 1: Julie Weatherington Rice – Clermont Deep Cores into Illinoian Till

Group 2: Mike Angle – Board Buses nearby for Back Bone Creek Till Cut

Groups Rotate

11:40- 12:00 – Drs. Bigham/Smeck/Ransom – OSU Lab Data and Research Sites including Fragic Properties and Water Table Data, Implications for Division of Clermont such as Westboro with Fragic Properties/Schaffer with a Fragipan in Ohio

12:00 – 12:45 – Catered Lunch (Roast Beef, Pork Loin, Potatoes, Vegetables, Salad, Rolls, Pie and Drink)

12:45 – Board Buses and Depart for Field Sites- Land Forms Discussion on Route

1:00 – 5:00 – Field Sites Examine Pits, Discussion of Implications for Soil Health, Drainage, Septics, and Hydric Soil Indicators

Stop 1, Etienne Farm (Wagon Shuttle to Pits)

2 pits – 1 in “cropped” Clermont, 1 in wooded Clermont site (Group Splits and Rotates).

-Matt Deaton to discuss Soil Quality Study from 2006 and lead Discussion.

Stop 2, Indian Creek Wildlife Area

2 Pits – 1 Each in Westboro/Schaffer Soils evaluating fragipan vs fragic characteristics

(Most in Ohio have been Split into Westboro/Shafer). (Group Splits and Rotates)

John Allen and Dr. Bigham to lead Discussion

5:00 - Return to Meeting Site and Travel to Winton Woods for Camping
<http://www.greatparks.org/parks/winton-woods/winton-woods-campground>
and Nearby Hotel Blocks Reserved at Special Rates in Northern Cincinnati:

Sept 14th at 7:00pm - Optional Meal Social at Pappadeaux 11975 Northwest Blvd., Springdale, OH 45246
<https://pappadeaux.com/location/42> (North side of I-275 just off of SR 4)
Email your Reservation by Aug. 31 to Frank Gibbs at
fegibbs21@gmail.com

Registration Sept 14th-Day One (Thursday)

A registration fee of \$55 for Day One includes the technical program, a catered lunch, and bus transportation between study sites. Lodging/camping is on-your-own. **Note: Students actively enrolled in a university program receive free registration from the Association of Ohio Pedologists for Day One but must register in advance.**

Professionals:

Send a personal check in the amount of \$55 made payable to the Association of Ohio Pedologists by August 25 to:

Mr. Jon Gerken
5890 Rauch Rd.
Carroll, OH 43112

Students:

Send the following information by September 1 to Mr. Jon Gerken at the above address:

Name: _____

University: _____

Program or Major: _____

Faculty Advisor: _____

Tentative Agenda and Registration (Day 2 in Indiana)

Agenda Sept 15th-Day Two (Friday)

2017 INDIANA ASSOCIATION OF PROFESSIONAL SOIL CLASSIFIERS ANNUAL FALL TOUR

SOUTHEAST PURDUE AGRICULTURAL CENTER

BUTLERVILLE, IN

September 15, 2017

9:00-9:30 REGISTRATION

9:30-10:00 WELCOME AND INTRODUCTIONS

10:00-10:30 OVERVIEW AND HISTORY OF FIELD SITES

10:30-12:00 TRAVEL TO AND REVIEW FIELD SITES/PITS IN AG LAND VS. FOREST LAND COBBSFORK AND AVONBURG SOILS

12:00-1:00 LUNCH/DOOR PRIZES

1:00-2:00 IAPSC BUSINESS MEETING

2:00-3:00 FIELD SITES IN CINCINNATI AND BLOCHER SOILS PIT – SEPTIC INTERPRETATIONS

3:00 ADJOURN – SAFE TRAVELS!

Registration Sept 15-Day Two (Friday)

A registration fee of \$25 for Day Two includes the technical program and lunch. Lodging/camping is on-your-own.

To register, send a personal check in the amount of \$25 made payable to the Indiana Soil Classifiers by September 1 to:

Ms. Dena Anderson

6939 S. Majors Rd.

Hanover, IN 47243

If you wish to use a credit card number you may contact Dena Anderson for more information. AOP currently does not have that capability.

The following photos are to get your fingers and lips moist. Plan on getting into the wild soil scientist habitat and getting a little Dirty...



AOP/IN Classifiers Workshop Committee Members at Purdue SE Ag Center setting up Pit Locations

1 WESTBORO AND SHAFFER PIT LOCATIONS IN INDIAN WILDLIFE AREA



Matt Deaton, AOP, shows typical fine platy structure in the surface of these high silt soil when farmed that restricts water movement.



Cobbsfork Soil Long Term Instrumented Site in Woods at Purdue SE Ag Center



Hydric Soil Indicator F₃, Depleted Matrix on Cobbsfork Soil



Crawfish Chimney with spike rushes, just inches lower in micro-topography than the newly planted soy bean field in the back ground on Cobbsfork Soils, illustrating how difficult these soils are to drain.



Fractured Illinoian Till along Backbone Creek in Clermont Co., OH.